

## Solid State Relay Accessory

### Thermal Pad

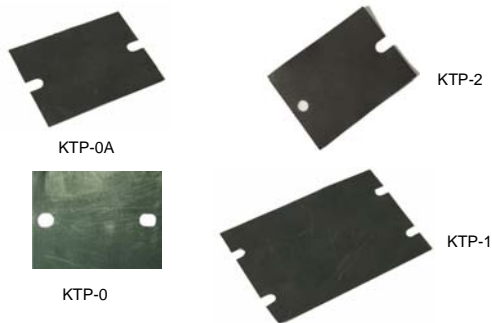

- Low Thermal Resistance
- KTP-0(A) apply for KSI, KSJ single phase relay
- KTP-1(A) apply for KMS, KMT, KMTY, KSQ, KSQC three phase relay
- Adhesive on one side (Optional)
- Silicon Resin / Glass Fiber or Graphite

### Product Selection

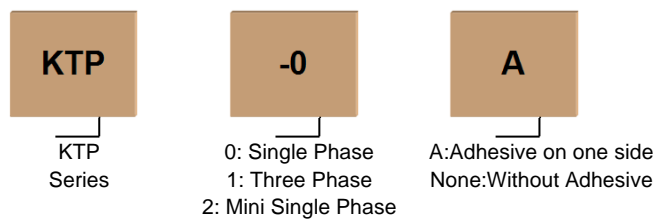

### Technical Specification

Color	Black	
Thickness	0.15mm	
Material	KTP-0A	Silicon Resin / Glass Fiber
	KTP-2	Silicon Resin / Glass Fiber
	KTP-0	Graphite
	KTP-1	Graphite
Adhesive One Side	KTP-0(A)	Optional
Thermal Resistance	KTP-0(A)	0.48°C-in <sup>2</sup> /W@25 psi
Thermal Conductivity	2.0W/m-K	
Flame Rating	V-O	
Continuous Temperature Range	-60°C ~ 180°C	
Storage conditions	KTP-0A	Temperature 23~27°C Humidity 65±20%rh
Weight (typical)	KTP-0(A)	0.4g
	KTP-1	0.9g
	KTP-2	0.16g

### Installation

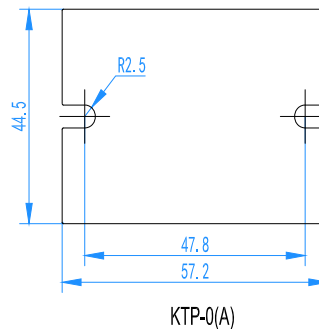
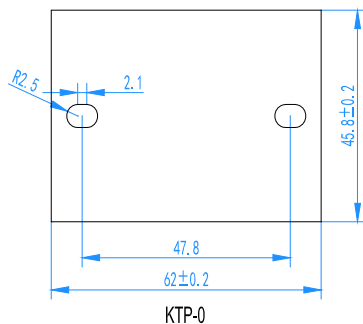

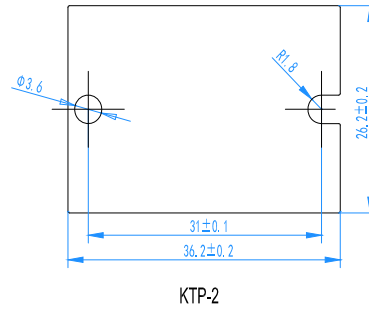
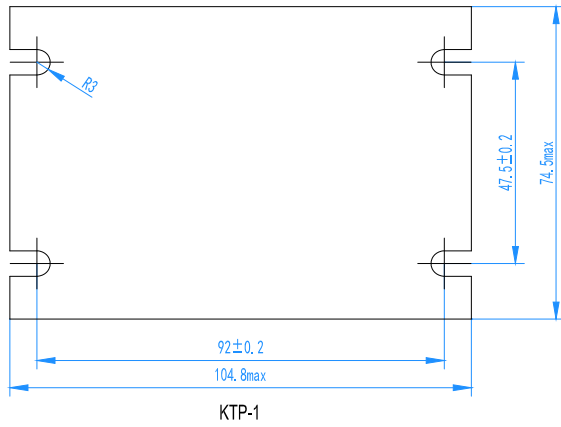

## Product Certification

